

Specification of Conductor:

Solid Conductor Cu ETP

Cross section: 50mm²

Designation: Lightning Protector // “Blitzableiter”

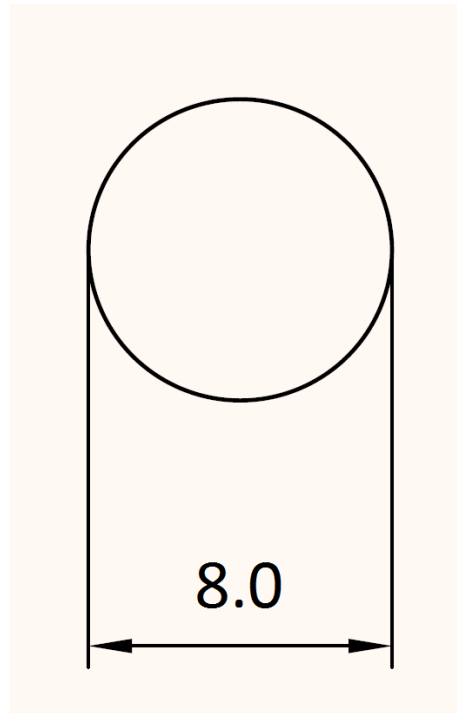

Technical properties :

| | | |
|------------------------------------|--------------------|--------------|
| Construction of conductor | | 1 solid wire |
| Diameter of conductor (+/- 0,08mm) | [mm] | 8,0 |
| Nominal Cross Section | [mm ²] | 50 |
| Min. Cross Section | [mm ²] | 49,26 |
| Max. Cross Section | [mm ²] | 51,27 |
| Max. Tensile strength: | [N/mm] | 270 |
| Weight of Conductor | [Kg/m] | 0,445 |
| Packaging information: | | |
| - Returnable spools, | | 400 kg each |
| - Coiled rings | | 50 kg each |